



**FILTER HOLDER  
GRILLE 595x595**

**US  
SERIES**

**OVERVIEW**

**OVERVIEW :**

The US series represented by a series of filter holder grilles suitable to all applications that require 595x595 dimensions, both wall and especially ceiling mounted. the grille is supplied without filter.

**CHARACTERISTICS :**

**Frame :** in extruded aluminium, with rounded edges built in 4 parts connected hidden by mechanical assembly.

**Body of diffuser :** can be in extruded aluminium with fixed angled blades like model UR (codes US-R), with aluminium egg create UQ type (codes US-Q), or in punched galvanised steel (codes US-L) with Ø 5 mm holes, 7 mm pitch alternative to 60° perforated area of 46%.

**Finishing :** depending on the models it can be in extruded steel (US-R), extruded aluminium frame and diffuser body in RAL 9010 (US-L)

**Counter frame :** made from anodised steel plate for assembly on walls or light structures.

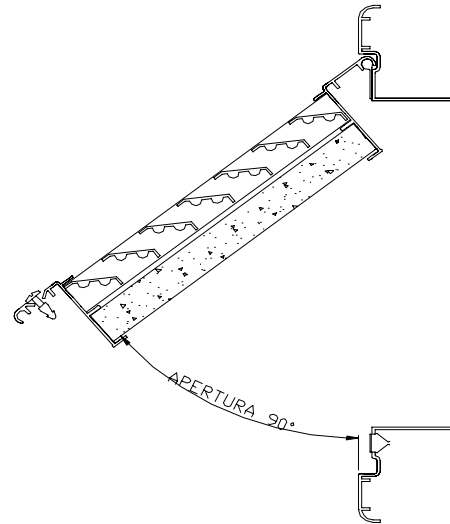

**MEASUREMENTS :**

**BUILDING DIAGRAMS :**

**MODELS :**

US-R

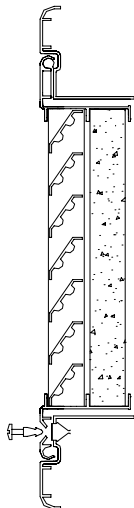

US-Q

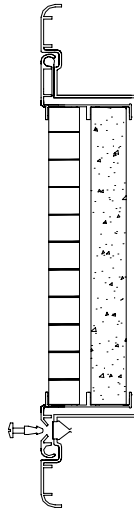

US-L

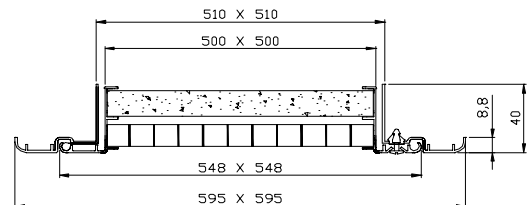
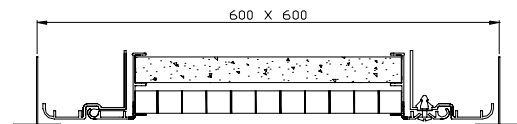
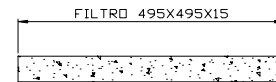
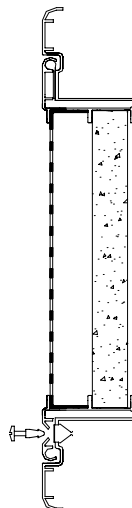



**FILTER HOLDER  
GRILLE 595x595**

**TECHINICAL DATA**

**US-R  
SERIES**

**FILTER HOLDER GRILLE MODEL US-Q 595X595**

Grille in extruded aluminium with fixed angled blades like model UR

The pressure values have been defined in the absence of a filter and possible damper

For the Lp dB(A) a chamber absorption 10 dB(A) was included.

US-R 595x595 WITHOUT FILTER			
	AIR FLOW (m <sup>3</sup> /h)	PS (Pa)	Lp dB(A)
minimum air flow	500	1,2	<20
	600	1,8	21
	700	2,2	24
	800	3,0	27
	900	4,1	29
	1000	5,0	32
	1500	13,0	42
maximum air flow	2000	22,0	48
	3000	50,0	59

US-R 595x595 WITH FILTER			
	AIR FLOW (m <sup>3</sup> /h)	PS (Pa)	Lp dB(A)
minimum air flow	500	21,2	<20
	600	22,8	21
	700	25,2	24
	800	28,0	27
	900	32,1	29
	1000	35,0	32
	1500	53,2	42
maximum air flow	2000	72,7	48
	3000	121,6	59



**FILTER HOLDER  
GRILLE 595x295**

**TECHINICAL DATA**

**US-R  
SERIES**

**FILTER HOLDER GRILLE MODEL US-Q 595X295**

Grille in extruded aluminium with fixed angled blades like model UR

The pressure values have been defined in the absence of a filter and possible damper

For the Lp dB(A) a chamber absorption 10 dB(A) was included.

US-R 595x295 WITHOUT FILTER			
	AIR FLOW (m <sup>3</sup> /h)	PS (Pa)	Lp dB(A)
minimum air flow	200	1,2	<20
	250	1,8	<20
	275	2,2	22
	325	3,0	25
	350	4,1	27
	400	5,0	30
	600	13,0	40
maximum air flow	800	22,0	46
	1200	50,0	57

US-R 595x295 WITH FILTER			
	AIR FLOW (m <sup>3</sup> /h)	PS (Pa)	Lp dB(A)
minimum air flow	200	21,2	<20
	250	22,8	<20
	275	25,2	22
	325	28,0	25
	350	32,1	27
	400	35,0	30
	600	53,2	40
maximum air flow	800	72,7	46
	1200	121,6	57



**FILTER HOLDER  
GRILLE 670x670**

**TECHINICAL DATA**

**US-R  
SERIES**

**FILTER HOLDER GRILLE MODEL US-Q 670X670**

Grille in extruded aluminium with fixed angled blades like model UR

The pressure values have been defined in the absence of a filter and possible damper

For the Lp dB(A) a chamber absorption 10 dB(A) was included.

US-R 670x670 WITHOUT FILTER			
	AIR FLOW (m <sup>3</sup> /h)	PS (Pa)	Lp dB(A)
minimum air flow	650	1,2	<20
	800	1,8	22
	900	2,2	25
	1050	3,0	28
	1200	4,1	30
	1300	5,0	33
	2000	13,0	43
maximum air flow	2600	22,0	49
	4000	50,0	60

US-R 670x670 WITH FILTER			
	AIR FLOW (m <sup>3</sup> /h)	PS (Pa)	Lp dB(A)
minimum air flow	650	21,2	<20
	800	22,8	22
	900	25,2	25
	1050	28,0	28
	1200	32,1	30
	1300	35,0	33
	2000	53,2	43
maximum air flow	2600	72,7	49
	4000	121,6	60



**FILTER HOLDER  
GRILLE 595x595**

**TECHINICAL DATA**

**US-Q  
SERIES**

**FILTER HOLDER GRILLE MODEL US-Q 595X595**

Grille with aluminium egg create UQ type

The pressure values have been defined in the absence of a filter and possible damper

For the Lp dB(A) a chamber absorption 10 dB(A) was included.

US-Q 595x595 WITHOUT FILTER			
	AIR FLOW (m <sup>3</sup> /h)	PS (Pa)	Lp dB(A)
minimum air flow	700	1,3	<20
	800	1,8	<20
	900	2,2	<20
	1000	2,8	<20
	1500	5,9	23
maximum air flow	2000	10,5	27
	3000	24,0	40

US-Q 595x595 WITH FILTER			
	AIR FLOW (m <sup>3</sup> /h)	PS (Pa)	Lp dB(A)
minimum air flow	700	26,3	<20
	800	28,8	<20
	900	31,2	<20
	1000	32,8	<20
	1500	43,9	23
maximum air flow	2000	62,5	27
	3000	99,0	40



**FILTER HOLDER  
GRILLE 595x295**

**TECHINICAL DATA**

**US-Q  
SERIES**

**FILTER HOLDER GRILLE MODEL US-Q 595X295**

Grille with aluminium egg create UQ type

The pressure values have been defined in the absence of a filter and possible damper

For the Lp dB(A) a chamber absorption 10 dB(A) was included.

US-Q 595x295 WITHOUT FILTER			
	AIR FLOW (m <sup>3</sup> /h)	PS (Pa)	Lp dB(A)
minimum air flow	275	1,3	<20
	300	1,8	<20
	350	2,2	<20
	400	2,8	<20
	600	5,9	21
maximum air flow	800	10,5	25
	1200	24,0	38

US-Q 595x295 WITH FILTER			
	AIR FLOW (m <sup>3</sup> /h)	PS (Pa)	Lp dB(A)
minimum air flow	275	26,3	<20
	300	28,8	<20
	350	31,2	<20
	400	32,8	<20
	600	43,9	21
maximum air flow	800	62,5	25
	1200	99,0	38



**FILTER HOLDER  
GRILLE 670x670**

**TECHINICAL DATA**

**US-Q  
SERIES**

**FILTER HOLDER GRILLE MODEL US-Q 670X670**

Grille with aluminium egg create UQ type

The pressure values have been defined in the absence of a filter and possible damper

For the Lp dB(A) a chamber absorption 10 dB(A) was included.

US-Q 670x670 WITHOUT FILTER			
	AIR FLOW (m <sup>3</sup> /h)	PS (Pa)	Lp dB(A)
minimum air flow	900	1,3	<20
	1050	1,8	<20
	1200	2,2	<20
	1300	2,8	20
	2000	5,9	24
maximum air flow	2600	10,5	28
	4000	24	41

US-Q 670x670 WITH FILTER			
	AIR FLOW (m <sup>3</sup> /h)	PS (Pa)	Lp dB(A)
minimum air flow	900	26,3	<20
	1050	28,8	<20
	1200	31,2	<20
	1300	32,8	20
	2000	43,9	24
maximum air flow	2600	62,5	28
	4000	99,0	41



**FILTER HOLDER  
GRILLE 595x595**

**TECHINICAL DATA**

**US-L  
SERIES**

**FILTER HOLDER GRILLE MODEL US-L 595X595**

Values of perforated to non perforated area 46%.

The pressure values have been defined in the absence of a filter and possible damper

For the Lp dB(A) a chamber absorption 10 dB(A) was included.

US-L 595x595 WITHOUT FILTER			
	AIR FLOW (m <sup>3</sup> /h)	PS (Pa)	Lp dB(A)
minimum air flow	500	1,7	<20
	600	2,3	<20
	700	2,9	<20
	800	3,9	<20
	900	4,9	<20
	1000	6,2	<20
	1500	14,1	23
maximum air flow	2000	25,5	31
	3000	59,7	41

US-L 595x595 WITHOUT FILTER			
	AIR FLOW (m <sup>3</sup> /h)	PS (Pa)	Lp dB(A)
minimum air flow	500	21,7	<20
	600	24,3	<20
	700	26,9	<20
	800	28,9	<20
	900	29,9	<20
	1000	36,2	21
	1500	55,1	24
maximum air flow	2000	77,5	33
	3000	125,0	43





**FILTER HOLDER  
GRILLE 595x295**

**TECHINICAL DATA**

**US-L  
SERIES**

FILTER HOLDER GRILLE MODEL US-L 595X295

Values of perforated to non perforated area 46%.

The pressure values have been defined in the absence of a filter and possible damper

For the Lp dB(A) a chamber absorption 10 dB(A) was included.

US-L 595x295 WITHOUT FILTER			
	AIR FLOW (m <sup>3</sup> /h)	PS (Pa)	Lp dB(A)
minimum air flow	200	1,7	<20
	250	2,3	<20
	275	2,9	<20
	325	3,9	<20
	350	4,9	<20
	400	6,2	<20
	600	14,1	21
maximum air flow	800	25,5	29
	1200	59,7	39

US-L 595x295 WITHOUT FILTER			
	AIR FLOW (m <sup>3</sup> /h)	PS (Pa)	Lp dB(A)
minimum air flow	200	21,7	<20
	250	24,3	<20
	275	26,9	<20
	325	28,9	<20
	350	29,9	<20
	400	36,2	<20
	600	55,1	21
maximum air flow	800	77,5	29
	1200	125,0	39



**FILTER HOLDER  
GRILLE 670x670**

**TECHINICAL DATA**

**US-L  
SERIES**

FILTER HOLDER GRILLE MODEL US-L 670X670

Values of perforated to non perforated area 46%.

The pressure values have been defined in the absence of a filter and possible damper

For the Lp dB(A) a chamber absorption 10 dB(A) was included.

US-L 670x670 WITHOUT FILTER			
	AIR FLOW (m <sup>3</sup> /h)	PS (Pa)	Lp dB(A)
minimum air flow	650	1,7	<20
	800	2,3	<20
	900	2,9	<20
	1050	3,9	<20
	1200	4,9	<20
	1300	6,2	21
	2000	14,1	24
maximum air flow	2600	25,5	32
	4000	59,7	42



US-L 670x670 WITHOUT FILTER			
	AIR FLOW (m <sup>3</sup> /h)	PS (Pa)	Lp dB(A)
minimum air flow	650	21,7	<20
	800	24,3	<20
	900	26,9	<20
	1050	28,9	<20
	1200	29,9	<20
	1300	36,2	22
	2000	55,1	25
maximum air flow	2600	77,5	34
	4000	125,0	44



## FILTER HOLDER GRILLE 595x595

US  
SERIES

CODES

Image	Description	Dimentions	Code	Thin filter with rigid frame
	filter holder grille with trurn grille 20 mm pitch in aluminium without rigid frame filter 15 mm thick, compass opening with half turn screw and lock mechanism.	595x595	US-R595595	FP15495495
		595x295	US-R595295	FP15495195
		670x670	US-R670670	FP15570570
	Filter holder grille with aluminium egg create 12,5mm and frame in anodised aluminium without rigid frame filter 15 mm thick, compass opening with hal turn screw and lock mechanism.	595x595	US-Q595595	FP15495495
		595x295	US-Q595295	FP15495195
		670x670	US-Q670670	FP15570570
	Filter holder grille in punched steel sheet RAL 9010 without rigid frame filter 15 mm thick, compass opening with a half turn screw and lock mechanism.	595x595	US-L595595	FP15495495
		595x295	US-L595295	FP15495195
		670x670	US-L670670	FP15570570

- US Filter holder grille
- R Grille diffuser body UR, 20 pitch
- Q Diffuser with aluminium egg create 12,5 pitch
- L Diffuser body in punched steel sheet RAL 9010

Example: US-R 595x595 - filter holder grille with supply grille 20 pitch in alluminium anodised 595x595, for rigid frame filter 495x495x15 not included, compass opening with half turn screw and lock fixing mechanism.

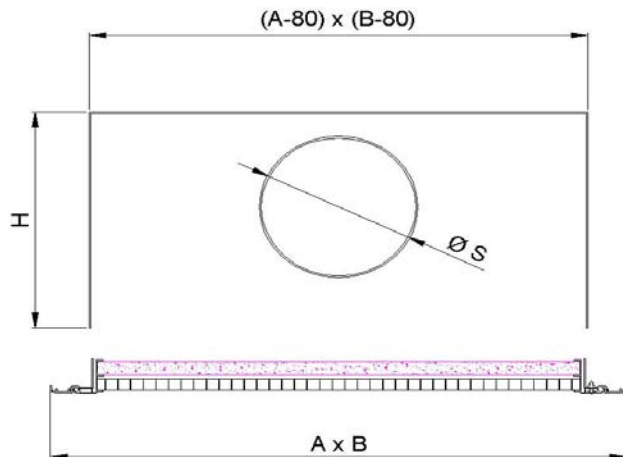

### PLENUM

H	Ø Separation S	Ø perforated for removal FE	Ø perforated for removal PL
250	150	162	150
250	160	170	160
250	200	213	200
300	250	264	250

